



Slice fruit and vegetables.



Dice fruit and vegetables.



Core or wedge fruit and vegetables.



Use the Cleaning Tool to remove food residue from the Pusher Plates.

INSTRUCTIONS:

Choose either Slice, Dice, Core/Wedge Blade and matching Pusher Plate for desired cutting. Carefully place the blade within the blade slot of the Transparent Container of the Veg-o-Matic Deluxe. Align the two blade notches to ensure a secure fit. Insert the Pusher Plate into the Pusher Lid (see parts diagram on back). Make sure the Pusher Plate and blades are properly in place.

Position the food or vegetable under the Pusher Lid and on top of the blade. If your food is too large to fit into the cutting area, cut in half with a knife first.

Press firmly and straight down (not at an angle) on the top of the Pusher Lid with the palm of your hand until food has passed all the way through the blade. For best results with firmer vegetables such as potatoes, push through forcefully and quickly with both hands.

IMPORTANT TIPS:

Make sure fruits and vegetables are firm and not over-ripe. For foods like tomatoes, potatoes and onions, cut a thin slice off the top and the bottom, creating a flat surface. Place the bottom flat surface in the center of the cutting area. Press the Pusher Lid quickly and firmly straight down.

CLEANING AND STORING INSTRUCTIONS:

Wash Veg-o-Matic Deluxe with warm soapy water and dry thoroughly.



Veg-o-Matic™

Deluxe



Ronco Holdings, Inc.
15505 Long Vista Dr., Ste 250
Austin, TX 78728
1-855-85-RONCO
www.Ronco.com



©2016 by Ronco Holdings, Inc. All Rights Reserved. 12.15 Model: FS2030BWGEN

Parts Diagram

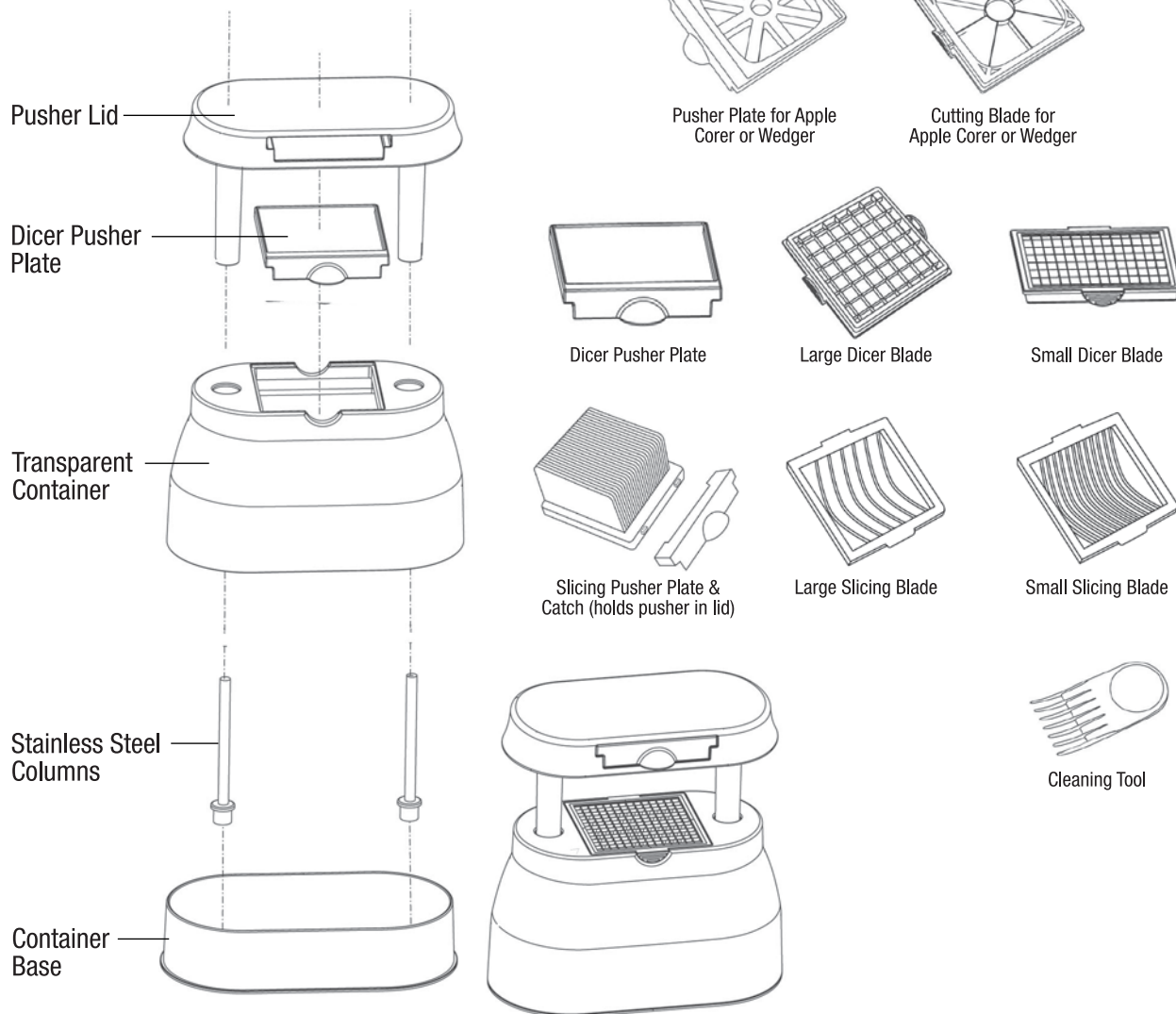

Assembly Instructions



Insert Stainless Steel Columns into Container Base.



Slide Transparent Container onto Stainless Steel Columns and Container Base.



Choose Pusher Plate and slide into Pusher Lid. Slicing Pusher Plate (shown above) comprised of two pieces; Plate and Catch.



Place Plate in upside down Lid. Then slide Catch into slot to secure Pusher Plate as shown.



Choose matching Blade and snap onto Transparent Container.



Slide columns on Pusher Lid into holes of Transparent Container. Pusher Lid will now move up and down with ease.



WARNING - Risk of injury!

- The blades are extremely sharp. Use with caution.
- Be careful when using and cleaning the blades.
- This is not a toy and should not be used by children.